

Product Installation Guidelines & Scope of Use

Version 2.1, 28 August 2025, Page 1 of 5
Document No.: 170.81.12.00

Ezy-Drink® Lead Safe™ Remote Electronic Drinking Bubbler Tap - Mains

PRODUCT CODES:

- 170.81.12.00

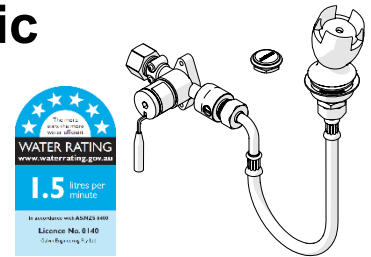

SPECIFICATIONS

- Drinking taps are designed to operate at full mains pressure.
- The rubber mouthguard is resistant to fungal and bacterial attack and has a high resistance to sunlight.
- Adjustable built-in flow restrictor.

IMPORTANT: All Ezy-Drink® remote bubbler taps are tested in accordance with AS 3718 and leave our premises in good working order.

*Our Lead Safe™ product range is compliant with the Lead Free Requirements of the NCC 2022 Vol. Three, Clause A5G4(2) and NSF/ANSI 372.

WARNINGS: Special attention to be paid on notes, photos, images, or drawings of assembly steps marked with the warning symbol. 

TECHNICAL DATA

Inlet			½" BSP - Female
Outlet			Rubber mouthguard
Headwork			Piezo Activation
Working Pressure Range (kPa)		Min	50
		Max	500
Working Temperature Range (°C)		Min	5
		Max	60
Nominal Flow Rate (LPM)			1.44
Power Supply	Type		Transformer
	Input		230-240V – 50Hz
	Output		6.75V DC 0.5A
Solenoid	Input Voltage		6 V DC
	Power Consumption		-
	Cable length		3.2m
	Pressure Range (kPa)	Min	50
		Max	500
	Temperature (°C)	Min	5
		Max	60
Finish			Chrome
NOTE: Galvin Engineering continually strive to improve their products. Specifications may change without notice.			

TOOLS REQUIRED

- Power drill
- Spanner or adjustable crescent
- Screw driver

PRE-INSTALLATION - MOUNTING DETAILS

- !** – If the mounting holes do not already exist, mark out and drill the holes in the bench/trough, as shown in rough-in dimensions.

Note: Supplied flexi hose length is 225mm long. Maximum distance between the solenoid and outlet is 210mm.

Note: Before installation, all lines must be flushed.

We recommend that a line strainer be installed prior to drinking taps to eliminate any foreign material.

Rough-In Dimensions

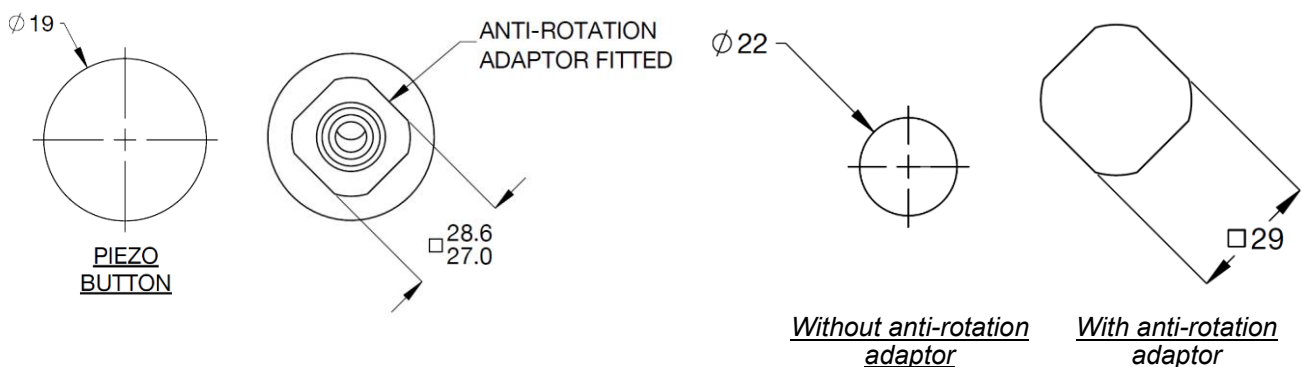

Product Dimensions

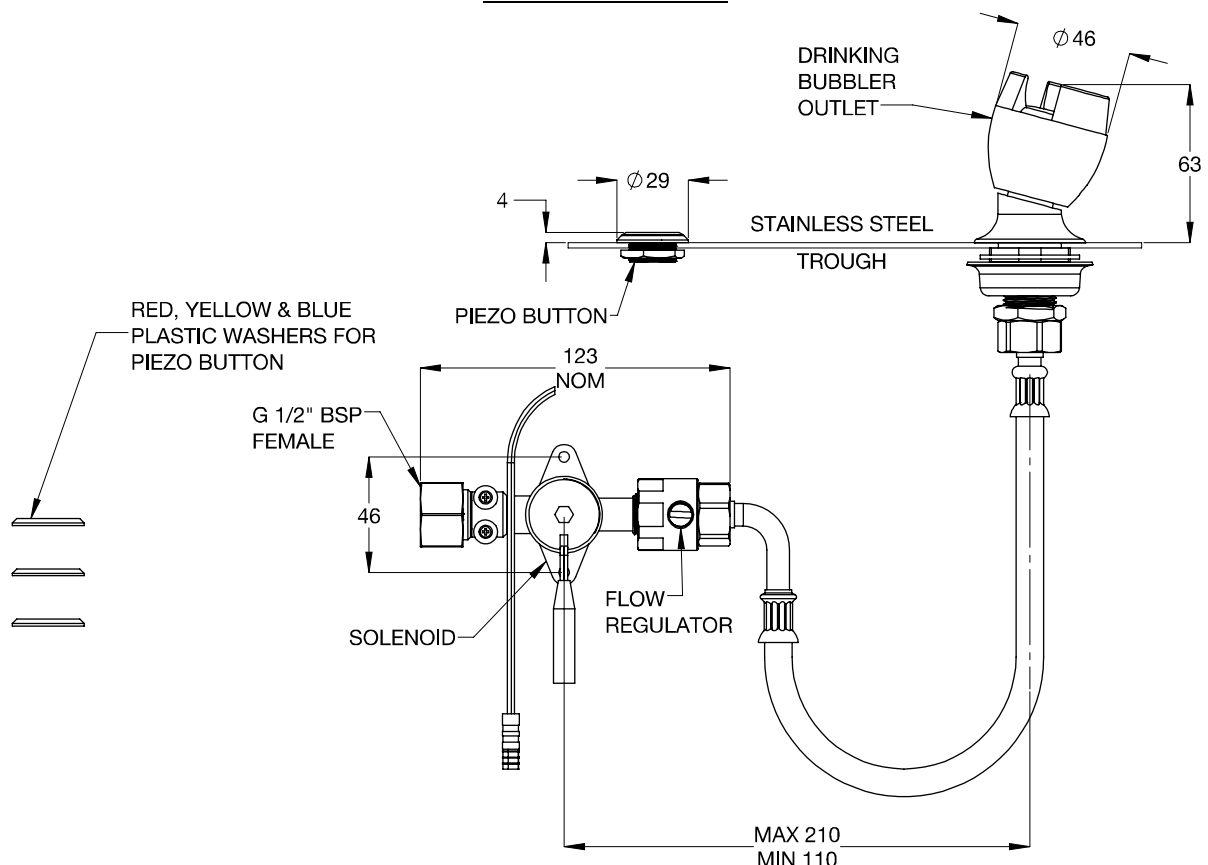

If specific changes need to be made to programming, contact Galvin Engineering.

! During the commissioning process, it's important to note that the controller comes with an automatic programming lock feature. Once the initial 15-minute programming duration expires after commissioning, programming access will be disabled. Rapidly pressing the piezo button during this 15-minute commissioning window can alter programming, leading to reprogramming the controller beyond its default manufactured setting. To avoid potential issues with product functionality, please refrain from attempting to modify the programming during the commissioning period.

INSTALLATION

IMPORTANT: Galvin Engineering products must be installed in accordance with these installation instructions and in accordance with AS/NZS 3500, the PCA and your local regulatory requirements. Water and/or electrical supply conditions must also comply to the applicable national and/or state standards. Failing to comply with these provisions shall void the product warranty and may affect the performance of the product.

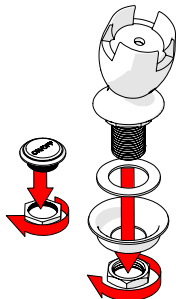

1. Disassemble piezo button and outlet

- Remove back nut and cup washer from the outlet assembly
- Remove back nut from piezo button

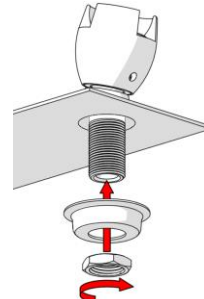

2. Fit mouthguard outlet

- Fit the body and mouthguard outlet into the trough.
- Ensure the sealing rubber washers are placed underneath the mouthguard outlet body.
- Secure underneath with the supplied cup washer and back nut.
- Take care not to over-tighten

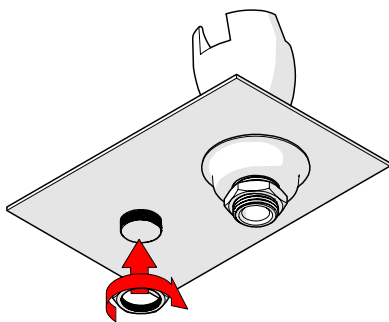

3. Fit Piezo Button

- Install piezo button and connect it to the electronic control unit.
- Ensure the correct coloured washer is fitted underneath the button.

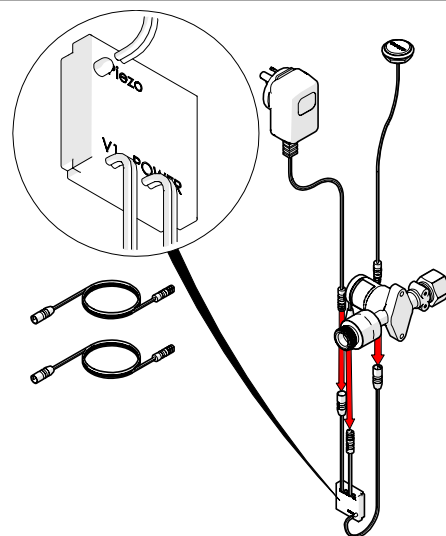

4. Connect Piezo Button, Solenoid and Transformer

- Connect Piezo button, the solenoid and the transformer to the electronic control unit.
- The unit was supplied with 2 x 3.2metre extension leads for connecting to transformer and solenoid.

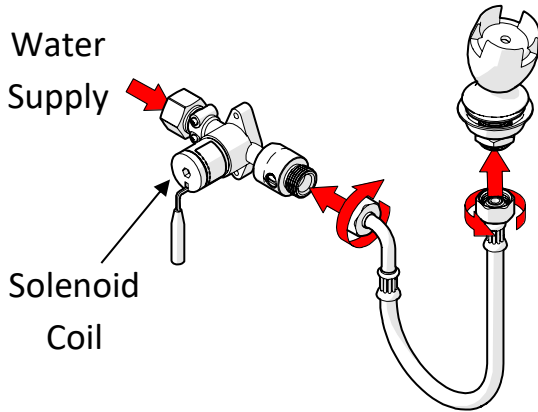

5. Fit Solenoid and Outlet

- Fix the solenoid in position ensuring that the solenoid coil is not facing downwards.
- Fit flexi hose to solenoid and water supply.
- Fit flexi hose to outlet

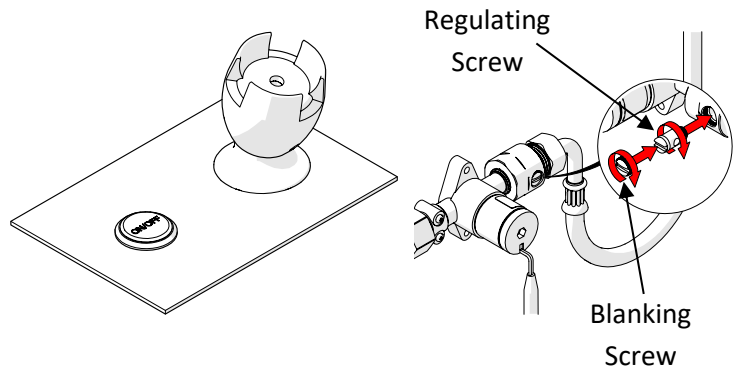

6. Testing

- Once the drinking tap has been installed and tested for leaks, the water height may be adjusted to suit the available pressure.
- To adjust water flow (if required)
 1. Remove the blanking screw
 2. Adjust the water flow by turning the regulating screw
 3. Replace blanking screw



Note: The full range from minimum flow to maximum flow is only ¼ turn

USING SQUARE ADAPTOR



IMPORTANT: If anti-rotation is required, use the square adaptor included with the product as shown below. Ensure rough-in dimensions for square adaptor in PRE-INSTALLATION are followed for correct fitment.

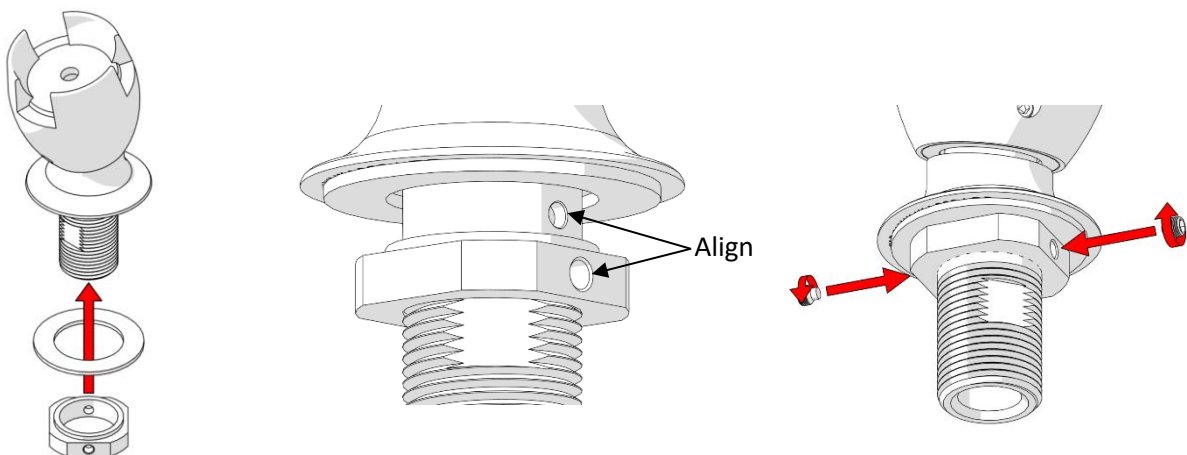

- Fit rubber washer then fit square adaptor.
- Align threaded hole on adaptor and the holes on the bubbler outlet.
- Fit and tighten grub screws as shown to secure square adaptor.
- Follow step 2 in INSTALLATION to install ensuring rough-in dimensions for square adaptor are followed.

SET WATER FLOW DURATION

Contact Galvin Engineering for information regarding changing flow duration.

TROUBLESHOOTING

PROBLEM	CAUSE	RECTIFICATION
Water is not flowing from tap	Water is turned off	Turn on water
	Blocked flow regulating screw	Remove flow regulating screw and clean
Rate of flow inadequate	The flow regulator screw may not be adjusted correctly	Remove blanking screw and adjust flow regulating screw as described above

WARRANTY

Galvin Engineering products are covered under our Manufacturer's Warranty. Galvin Engineering products must be installed in accordance with the installation instructions and in accordance with AS/NZS 3500 and NCC Volume Three, relevant Australian Standards and local authorities applicable to product being installed. Water and electrical supply conditions must also comply to the applicable national and/or state standards, failing to comply with these provisions may void the product warranty and affect performance of the product.

Please visit www.galvinengineering.com.au to view the full warranty, our Installation Compliance and Maintenance & Cleaning information as well as any other additional information.

Within Australia: 1300 514 074 Outside Australia: P: +61 (0)8 9338 2344

F: +61 (0)8 9338 2340

sales@galvinengineering.com.au

www.galvinengineering.com.au

ABN: 78 008 719 382

PERTH | SYDNEY | MELBOURNE | BRISBANE | ADELAIDE

